

MAKE BLUEY'S BUS



WHAT YOU'LL NEED:

- A cardboard box (the size you'd like your bus to be)
- Some extra cardboard for the wheels
- PVA glue
- Some paint to decorate
- You'll also need these tools



GET A GROWN UP TO HELP WITH THESE:



WHAT YOU'LL NEED TO DO:

1. Outline the box with the shape of the windows using your permanent marker. You can make windows on the front, the back and the sides of the bus.



Unfold your box and cut out the windows using a utility knife. You'll need a grownups help for this step.

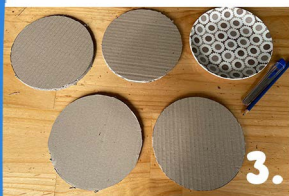
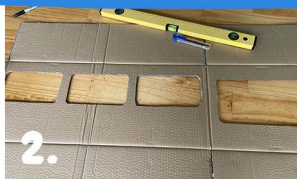

Use a plate to outline 4 wheels and then use your utility knife to cut them out.



Cut out and stick a cardboard outline for your windows!



Stick your box all back together using glue. You may wish to cut a hole at the top of your bus so you can easily access the inside when playing Bus!

Using any spare cardboard you can make some side mirrors and a dashboard. Stick these on as well as the wheels in place using your PVA glue.



7. Now it's ready for decoration! You can paint and decorate your bus in any way you'd like.

